

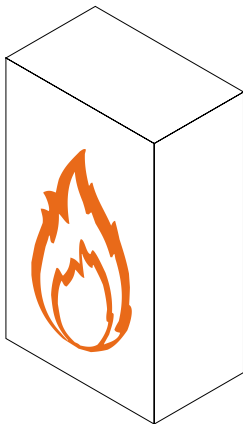

## Fire Rated Mailboxes



The Safety Letterbox Company in association with the Fire Research Laboratory worked together to create a range of 1 hour fire rated (integrity only) mailboxes.

Particularly suitable when mailboxes can only be positioned within a designated fire escape route or banked in a post room which must be fire rated.

The products in this section were required to satisfy the integrity criteria given in BS476 Part 22 1987 Clause 8 for a period of 60 minutes.

In addition to the above, the mailboxes can be further enhanced by applying a finish which would conform to London Underground surface spread of flame requirement BS476 Part 6 & 7.

## Fire Rated Steel PPC

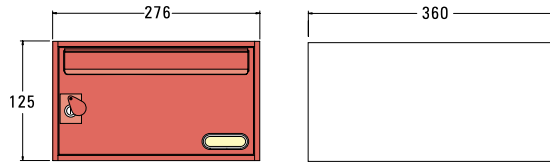
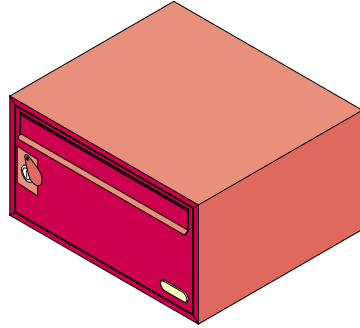

*Fire Rated Steel Horizontal*

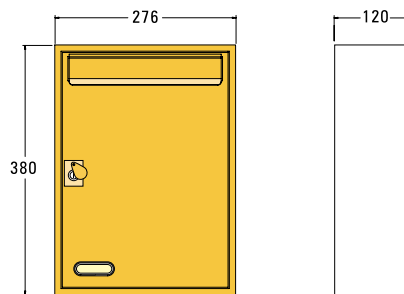
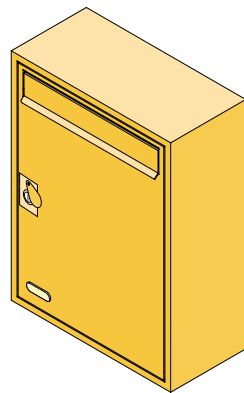

*Fire Rated Steel Vertical*

- Manufactured from galvanised steel finished with an architectural grade powder coating. Can also comply to London Underground surface spread of flame specification
- Strategically placed intumescent closures
- Suitable for domestic and commercial use
- For interior application
- Single unit weight 4k
- Suitable for surface fixing, free standing wall recessing and panel fixing
- Can be manufactured in banks to suit required configurations and client requirements
- Special fire rated locking mechanism
- Vandal resistant
- Our technical department will consider each site requirement individually

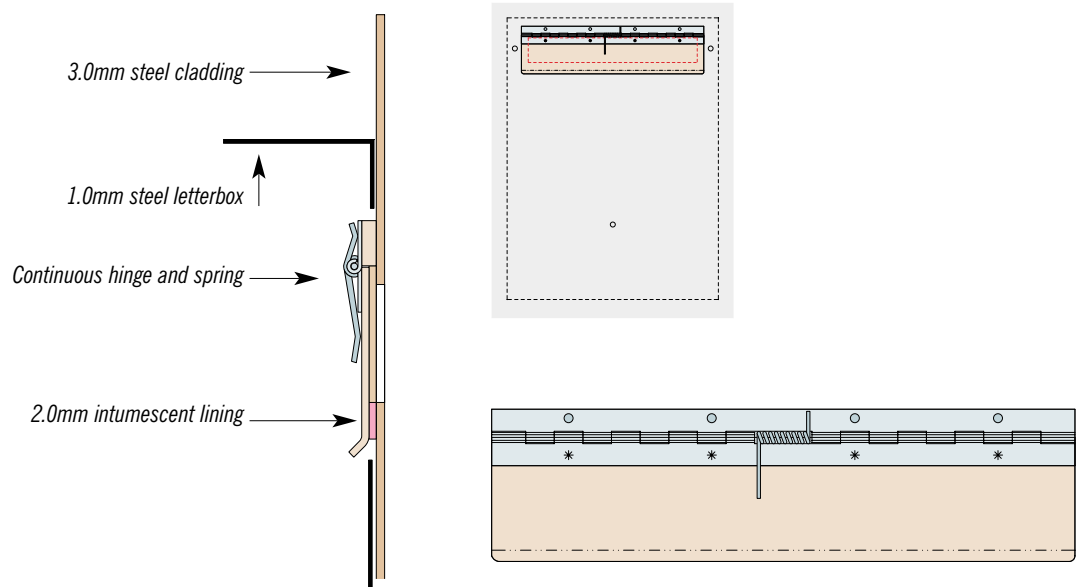

THE SAFETY  
LETTERBOX  
COMPANY LTD



**The Safety Letterbox Company  
Unit 1B, Milland Industrial Estate  
Milland Road,  
Neath SA11 1NJ**

**Telephone: (01639) 633525**

**Facsimile: (01639) 646359**

**Web: [www.safetyletterbox.com](http://www.safetyletterbox.com)**

Whilst all reasonable care has been taken in the preparation of this literature, all recommendations or suggestions regarding the use and application of products are made without guarantee, since conditions of use are beyond our control. Owing to a policy of constant improvement, information herein is subject to change without notice.

© The Safety Letterbox Company Ltd. 2005.  
No part of this literature may be reproduced without the permission of The Safety Letterbox Company Ltd.