

# NRV 1010

Wafer double door check valve – DN 50-600



Wafer double door check valve for heating and cooling systems. Available in pressure class PN 16 and 25.

**TA-SC**

**Distributed by TA Hydraulics**



## Technical description

---

**Applications:**

Heating and cooling systems.

**Function:**

Uni-directional flow.

**Dimensions:**

DN 50-600

**Pressure class:**

PN 16 and PN 25.

**Temperature:**

Max. working temperature: 120°C

Min. working temperature: -10°C

**Material:**

Body: Cast iron EN-JL1040 (PN 16), Ductile iron EN-GJS-500-7 (PN 25)

Disc: Stainless steel X5CrNi18-10+AT (EN 10088-2, BS 970 304S15)

Seat: EPDM

Hinge pin: Stainless steel X20Cr13+A (EN 10088-2, BS 970 420S37)

Stop pin: Stainless steel X20Cr13+A (EN 10088-2, BS 970 420S37)

Pin retainer: Stainless steel X5CrNi18-10+AT (EN 10088-2, BS 970 304S15)

Spring: Stainless steel X5CrNi18-10+AT (EN 10088-2, BS 970 304S15)

Washer: PTFE

Gasket: EPDM

**Surface treatment:**

Coated in Pantone 424 dark grey paint.

**Marking:**

TA-SC, CE, PN and DN.

**Flanges:**

One piece cast iron, suitable for use between flanges drilled in accordance with BS EN 1092-2, PN 10, PN 16, BS 10 Table D or E and ANSI 125.

**Face to face:**

According to ISO 5752.

**Approvals:**

WRAS (PN 16 only)

# Installation

Suitable for installation in vertical and horizontal pipelines.

**NB:** When installed in vertical pipe the flow must be upwards.

# Articles

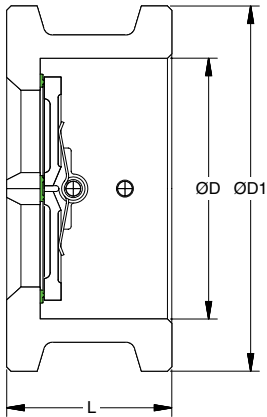

## PN 16

Article No	DN	D	D1	L	Kg	Kvs
77 101-050	50	66	106	54	1,8	54
77 101-065	65	78	126	54	2,4	89
77 101-080	80	90	141	57	3,2	150
77 101-090	100	115	161	64	4,8	310
77 101-091	125	141	191	70	7,3	510
77 101-092	150	170	217	76	10	730
77 101-093	200	210	272	95	14	1400
77 101-094	250	273	327	108	24	2100
77 101-095	300	324	382	143	38	3400
77 101-096	350	356	442	184	60	4000
77 101-097	400	406	494	191	77	5100
77 101-098	450	457	554	203	99	6700
77 101-099	500	508	616	213	115	8700
77 101-001	600	600	733	222	232	13000

## PN 25

Article No	DN	D	D1	L	Kg	Kvs
77 101-150	50	66	106	54	1,8	54
77 101-165	65	78	126	54	2,4	89
77 101-180	80	90	141	57	3,2	150
77 101-190	100	115	161	64	4,8	310
77 101-191	125	141	191	70	7,8	510
77 101-192	150	170	217	76	11	730
77 101-193	200	210	272	95	15	1400
77 101-194	250	273	327	108	25	2100
77 101-195	300	324	382	143	39	3400
77 101-196	350	356	442	184	62	4000
77 101-197	400	406	494	191	80	5100
77 101-198	450	457	554	203	102	6700
77 101-199	500	508	616	213	118	8700
77 101-101	600	600	733	222	235	13000

Kvs = m<sup>3</sup>/h at a pressure drop of 1 bar and fully open valve.

The products, texts, photographs, graphics and diagrams in this brochure may be subject to alteration without prior notice or reasons being given.

For the most up to date information about our products and specifications, please visit [www.tahydraulics.com](http://www.tahydraulics.com).

6-10-10 NRV 1010 03.2011

