



Metal Profiles and Accessories

10/2009

Knauf Metal Profiles and Accessories

New: Precision-engineered metal profiles and accessories for complete drywall systems



Knauf Metal Profiles

Knauf metal profiles are precision-engineered, high-quality steel sections that are used to form the metal substructure of the Knauf Drywall Systems. All metal sections produced from high-grade hot dip galvanized steel coils with the cold-rolled forming process in Knauf R.A.K. FZE factory located in the Emirate of Ras Al Khaimah, UAE.

The main design criteria's for Knauf metal sections are:

- **Quality:** Knauf only works with ISO 9001 certified raw material suppliers to guarantee its steel quality. High grade hot dip galvanized zinc coating (min. Z140 class) provides maximum protection against corrosion.
- **Rigidity:** Knauf profiles produced from sturdy 0.6 mm thick galvanized steel can meet the statical requirement of the most demanding projects.
- **Simplicity:** Minimum amount of accessories and 'twist to fit' studs and channels are designed to make the installer's job as simple as possible.
- **Compatibility:** Knauf metal sections are specially designed to work and perform together with Knauf gypsum boards and accessories to create complete, tested and certified systems.
- **Variety:** A wide range of sizes and options allows designers to find solutions that exactly match their requirements.

Knauf Metal Profiles Raw Material Specification

Steel	Quality Classification	:	DX51D+Z140 as per EN 10327:2004
	Yield Strength	:	295 Mpa
	Tensile Strength	:	345Mpa
	Elongation in 80mm	:	25%
	Hardness (HRB)	:	64
Protection	Method	:	Hot Dip Galvanization
	Quality	:	98% Zinc (Zn)
	Coating Classification	:	Z140 as per EN10327
	Coating Thickness	:	140gr/m ² both sides 10μ m single side
	Coating Finish	:	Normal Spangle (N)
	Surface Quality	:	As-coated surface (A)
	Surface Treatment	:	Chemical Passivation (CA)

*Z140 is the standard coating thickness for Knauf Drywall Systems profiles. Higher coating thicknesses are available upon request. Contact Knauf Drywall Systems sales team for availability and delivery times.

Steel Character

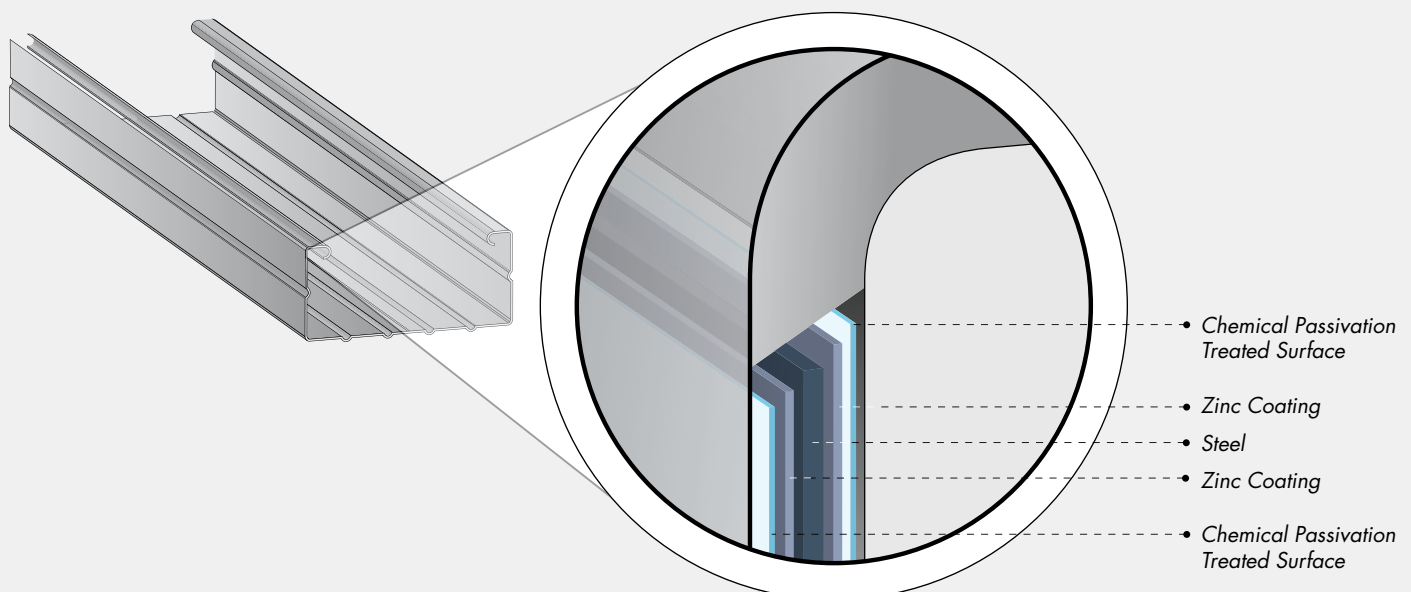

Knauf Metal Sections and Their Application Areas

Partitions

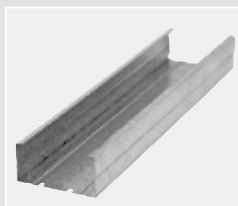

Knauf CW + and CW Studs
C shaped profiles friction fit at equal distances into the head and base UW channels to form the vertical metal stud frame



Knauf UW Tracks
U-shaped profiles used for forming the floor and ceiling perimeter frame in drywall partitions



Knauf Deep Flange UW Tracks
U-Shaped profiles used to ceiling perimeter form where high deflection tolerance is required

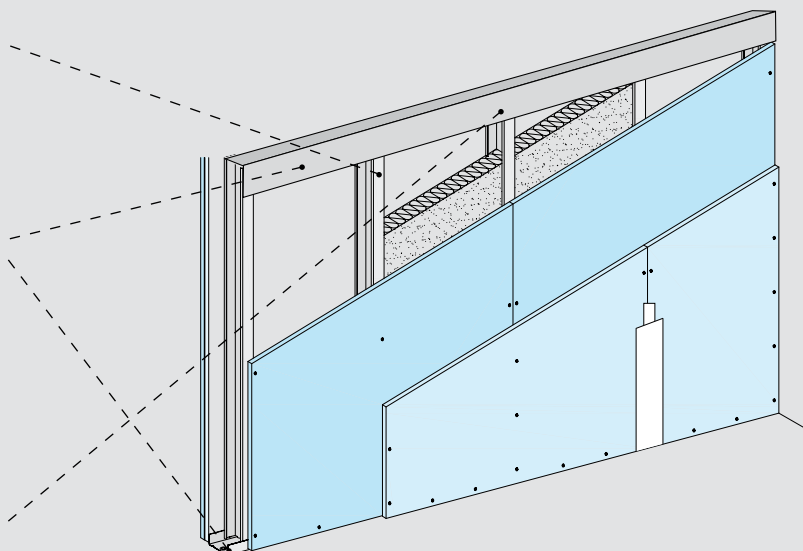

Wall Linings / Furrings



Knauf CD 60/27 and CD50/27 Channels
C-shaped channels used for vertical framing in Knauf W623 Wall Lining Systems



Knauf UD 28/27 Channels
U-Shaped channels used for perimeter framing for Knauf W623 wall lining systems

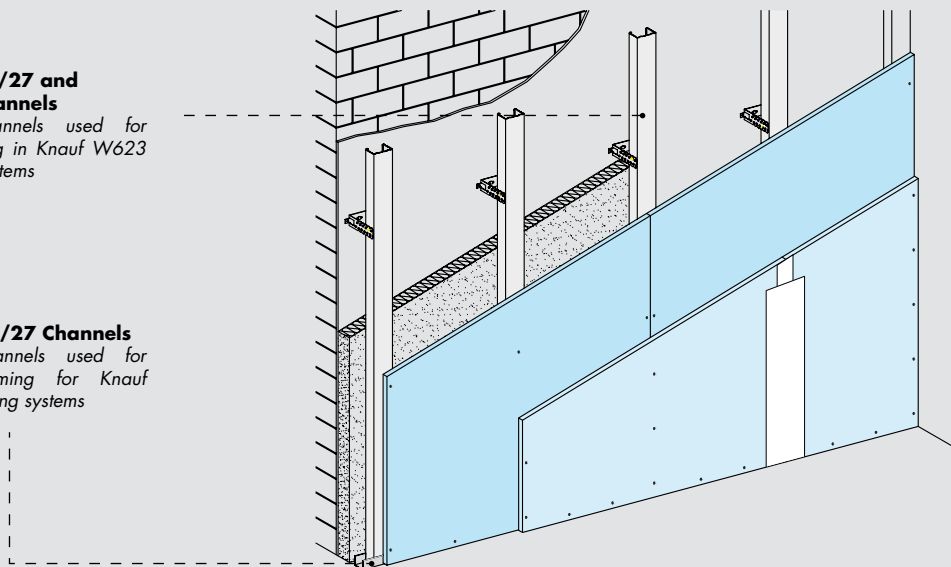

Knauf Metal Sections and Their Application Areas

Shaftwalls

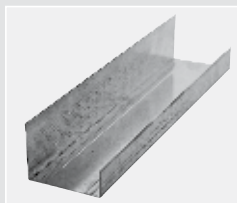

Knauf J Track
J shaped channels used to form the perimeter frame



Knauf C-T Studs
C-T shaped heavy duty steel sections used to form the vertical frame

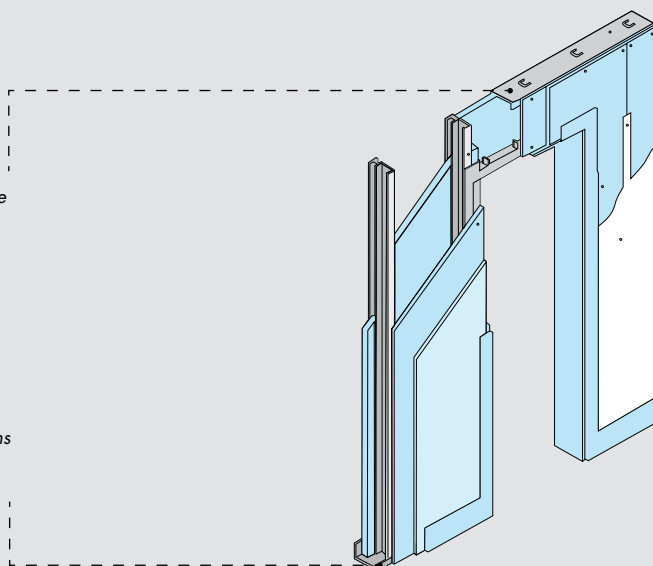

Ceilings



Knauf Main Channel
Galvanized lightweight steel section to be used as main channels for conventional drywall ceiling systems



Knauf Hat Furring Channel
Galvanized lightweight steel sections to be used as furring channels for conventional drywall ceiling and wall lining systems.



Knauf L Angle Channel
Galvanized lightweight steel section to be used as perimeter framing for conventional drywall ceiling systems



Knauf CD 60/27 and CD50/27 Channels
C-shaped channels used for main/upper and furring/lower channel in Knauf Ceiling Systems



Knauf UD 28/27 Channels
U-Shaped channels used for perimeter framing for Knauf D11 Ceiling systems

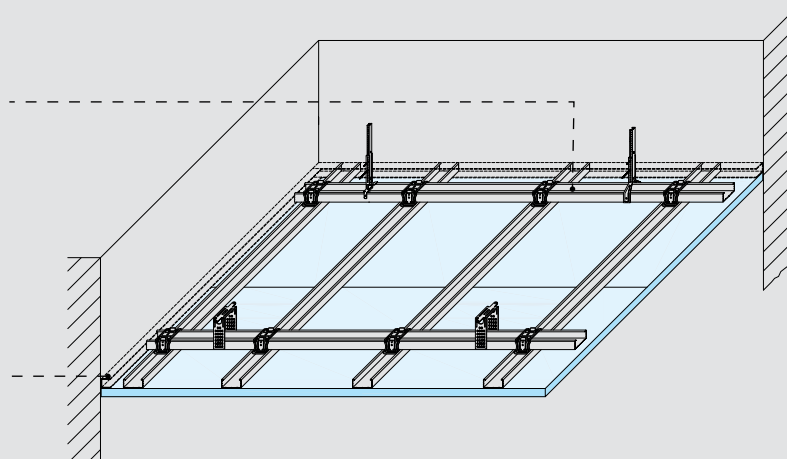
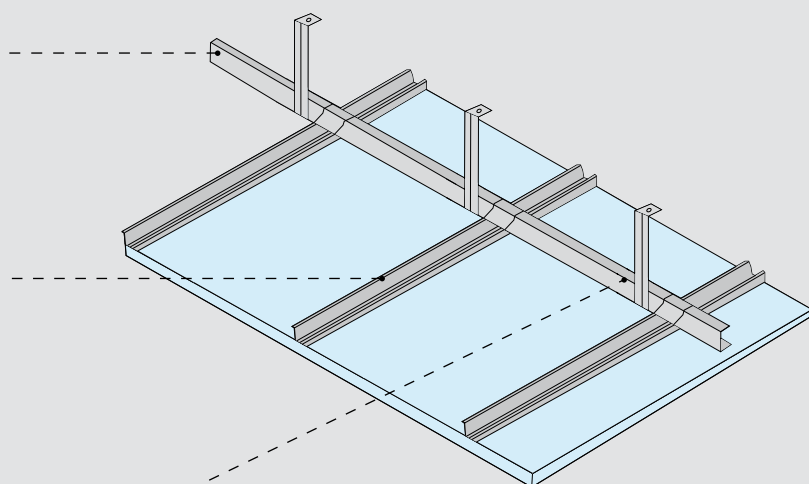

10 facts about Knauf CW+ Studs and CD Channels

- 1.** 0.6mm metal thickness for sections that are robust, strong and durable
- 2.** Deep dotted flanges allow easy catching of screws and faster screwing times
- 3.** Central indentation allows easy alignment of gypsum board joints
- 4.** 44 mm long flanges allow faster board alignment and joint treatment for higher wall height performance even with 600mm spacing (provides 37 % more surface than standard C-studs)
- 5.** Asymmetric flanges heights allow easy boxing of studs
- 6.** H-shaped slots allow easy installation of MEP cabling

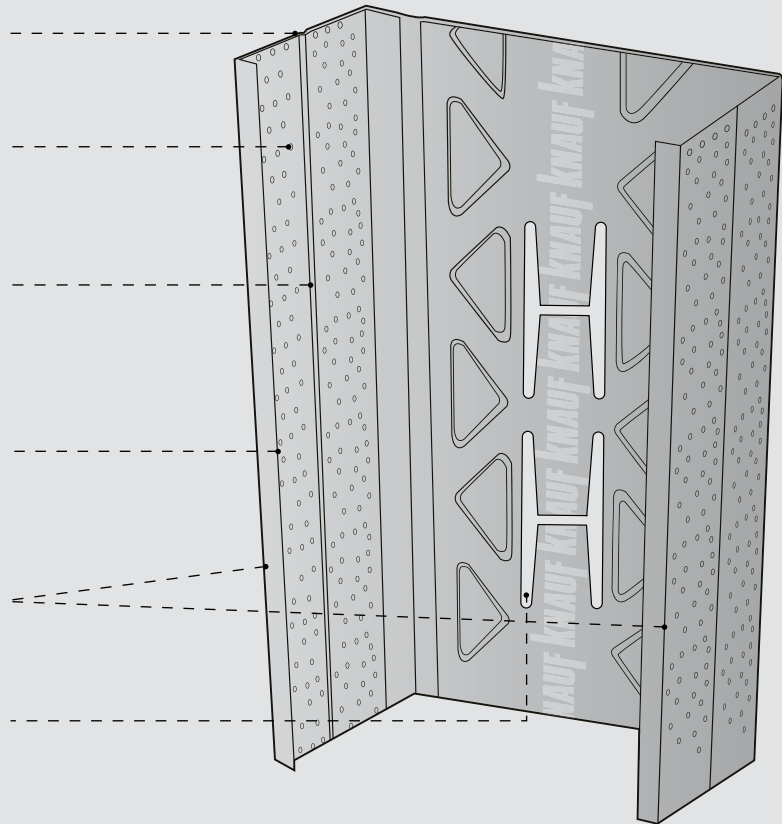

Knauf CW+ 50 Studs

- 7.** 50 mm web part allows much easier board alignment, screwing and joint treatment (provides 42% more space than standard hat furring channels)
- 8.** Triple indentation enhances the rigidity of the channel
- 9.** Special lip design increases the load capacity of the system and provides a better locking mechanism for suspension accessories
- 10.** A multifunctional design allows the same channel to be used both for wall linings and ceilings

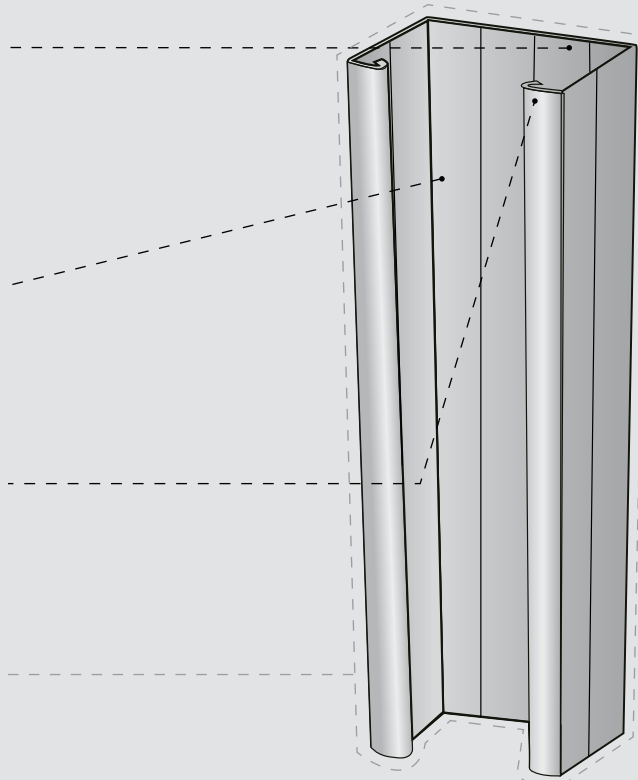

Knauf CD 50/27 Channels

How to Identify a Knauf Metal Section On-Site

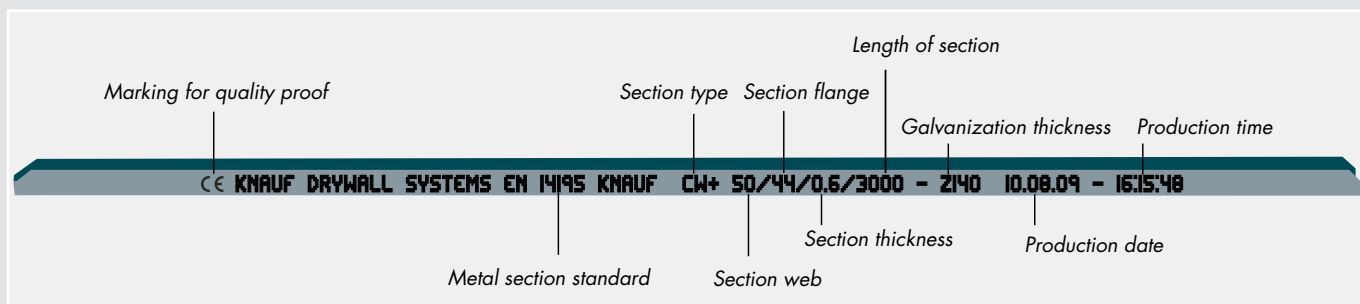

Example use of Knauf metal profiles in partitions

Knauf Metal Accessories

As part of its "complete drywall system" approach, Knauf also provides a full set of accessories specifically designed to be used with Knauf metal sections to construct the metal substructure for certified drywall systems. All of the accessories are produced from high grade steel with Z200 coating as per to EN 10327.

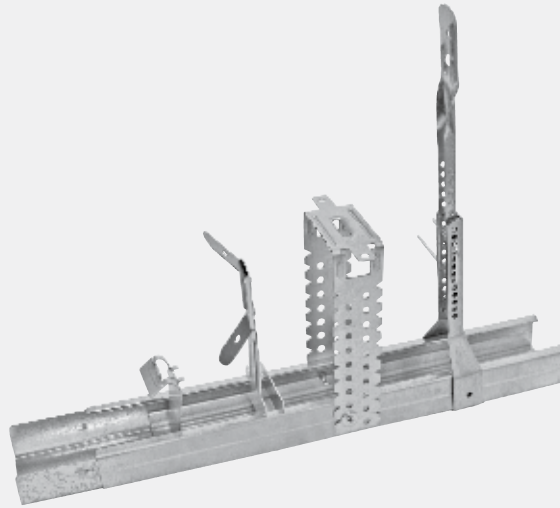

** For illustration purposes only.*

Knauf Ankerfix

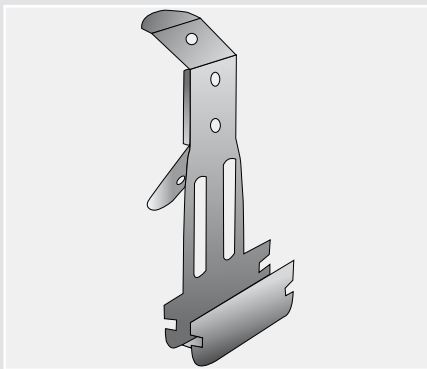

Anchor type suspender for attaching hanger wires to Knauf CD channels. Designed exclusively to be used with Knauf D11 Ceiling System. **(Load bearing capacity class = 25 kg.)**



Knauf Hanger Wire

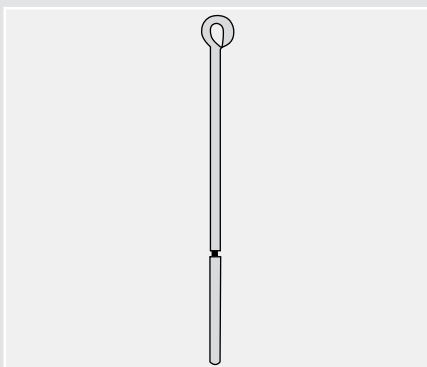

Galvanized 4.0 mm thick steel wires used as suspenders for Knauf D11 Ceiling System. Knauf hanger wires are fixed to the basic ceiling with the help of ceiling dowels and are connected to the metal grid with the help of Knauf Ankerfix. Recommended for suspension heights up to 2.00m. **(Load bearing capacity class = 25 kg.)**



Accessories

Nonius Suspension System

Alternative heavy duty suspension system to be used with Knauf CD channels. The system consists of 3 parts:

Nonius Hanger Top

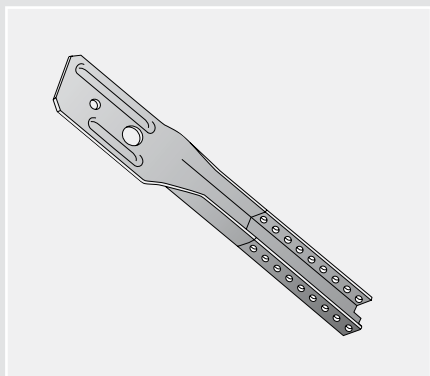

Fixed to structural slab. Available in various lengths up to 5.00m.

Nonius Pin

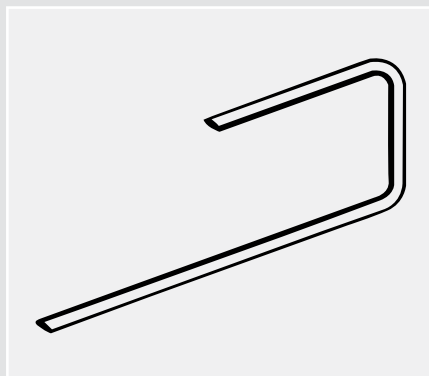

Middle part of the system which is used to attach the Nonius Hanger Top to Nonius Stirrup.

Nonius Stirrup

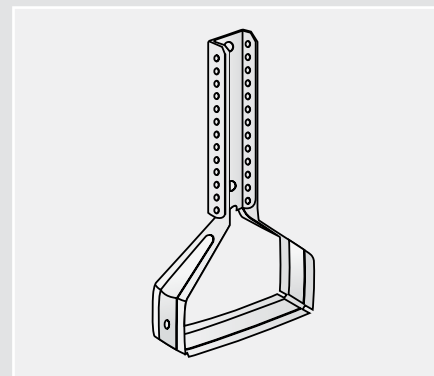

Bottom part of the system which is attached to CD channels. Available for CD 50/27 and CD 60/27 channels.

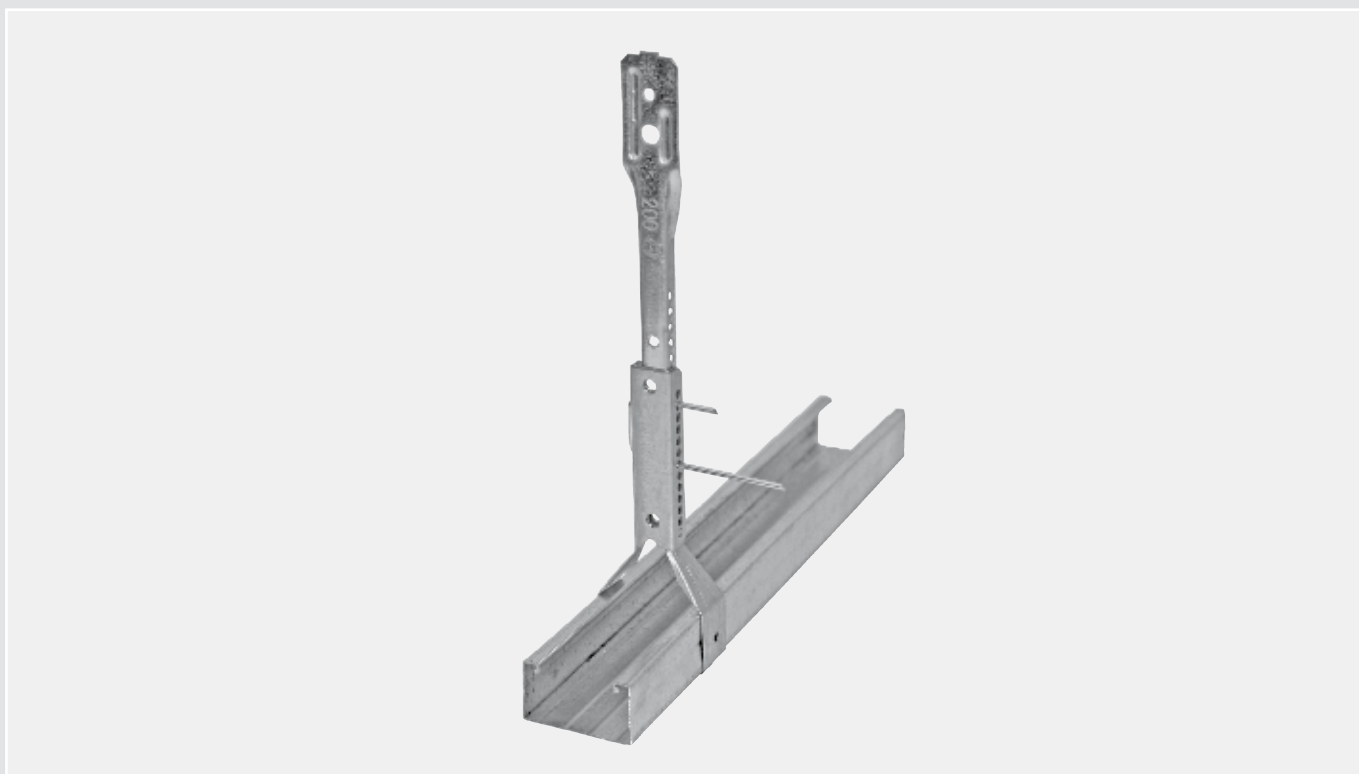

Recommended for suspension heights up to 5.00 m (**Load Bearing Capacity of System= 40 kg.**)

Accessories

Universal Bracket

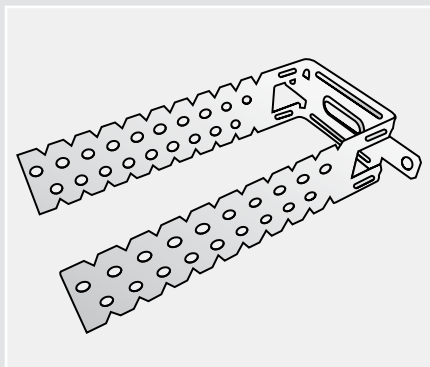

Accessory used as adjustable brackets for Knauf W623 Wall Lining System or as suspenders for Knauf D11 Ceiling System. Attaches to Knauf CD Channels with LN 3,5 screws. Can be cut and bend according to the suspension height. Designed exclusively to be used with Knauf D11 Ceiling System and W623 Wall Lining System. **(Load bearing capacity class = 40 kg.)**



Multiconnector

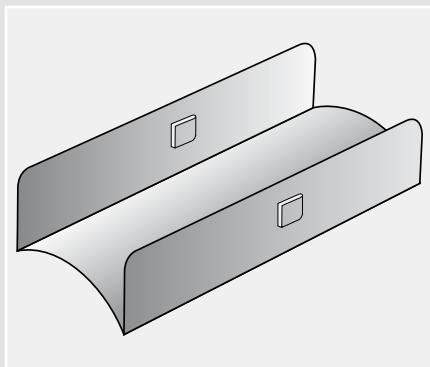

Galvanized connector piece used for extending Knauf CD Channels in cases of long spanned ceilings. Designed exclusively to be used with Knauf D11 Ceiling System and W623 Wall Lining System.



Clips

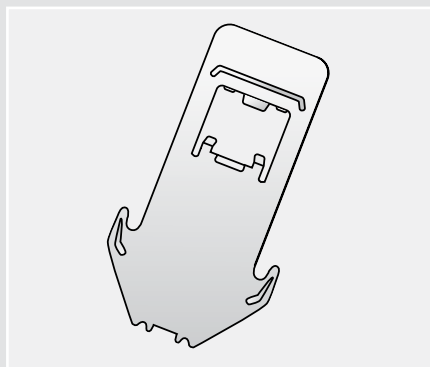

Galvanized clips to connect the main/primary CD channels to the lower/furring CD channels forming the Knauf D112 ceiling grid. Designed exclusively to be used with Knauf D112 Ceiling System.

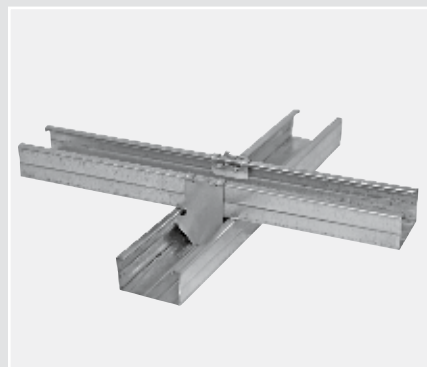

Accessories

Universal Connector

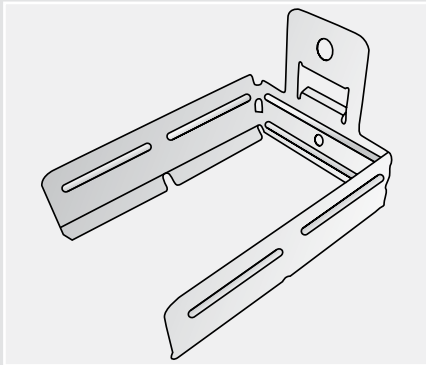

Galvanized accessories to connect Knauf CD Channels at intersection points in the Knauf D113 System grid. 2 Universal Connectors per intersection point.

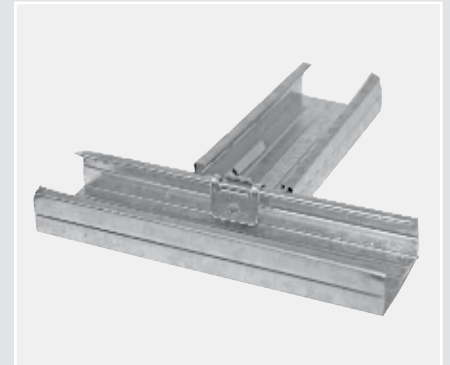

Example use of Knauf metal profiles and accessories in ceiling applications



Knauf CW+ Studs

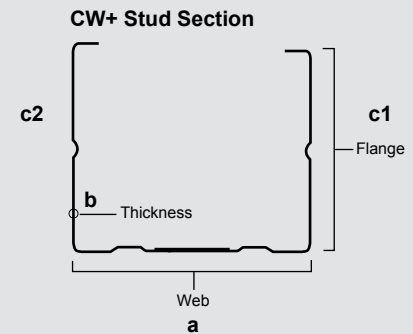
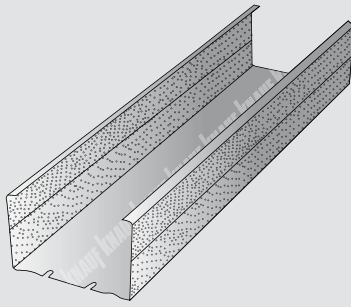

Knauf CW+ Studs are specially engineered steel sections for fast-track and high-quality drywall constructions. They are specifically designed for Knauf W11 Partition and W62 Wall Lining Systems. The combination of their sturdy 0.6 mm metal thickness and 44 mm flanges allows the partitions to have the highest possible wall heights with minimum consumption of studs, making the partitions both economic and stable. Knauf CW+ Studs are ideal for high-end commercial, residential, hospital and hotel projects. All CW+ Studs comply with EN14195.

For more information on wall heights / fire protection / sound ratings please refer to W11 Technical Datasheet.

Features:

- ✓ Sturdy 0.6 mm steel section
- ✓ 44 mm long flanges provide faster installation times and increased maximum wall heights
- ✓ Deep dotted flanges allow faster screwing times and enhance stiffness of the sections
- ✓ Knauf logo embossed at the web part allows easy identification on-site
- ✓ Asymmetrical flanges allow easy boxing of studs when necessary
- ✓ Readymade slots through the web allows easy electrical cabling and piping through partition cavity

Mat.Code	Stud Type	Stud Web (a) (mm)	Stud thickness (b) (mm)	Stud Flange (c1,c2) (mm)	Stud Length ⁽¹⁾ (mm)	Weight (kg/m)	Zinc Coating Class ⁽²⁾ (g/m ²)
16482	Knauf CW+50 Stud	50	0.6	44/42	3000	0.642	Z140
16483	Knauf CW+70 Stud	70				0.733	
16484	Knauf CW+75 Stud	75				0.756	
16485	Knauf CW+92 Stud	92				0.832	
16486	Knauf CW+146	146				1.077	

(1): 3000mm is the standard retail sales length of the studs. For customized stud lengths please contact Knauf LLC Sales Team

(2): Z140 is the standard retail zinc coating thickness sufficient for interior drywall applications. Higher zinc coated stud production also possible. For customized zinc coating requirements please contact Knauf LLC sales Team

Knauf CW Studs

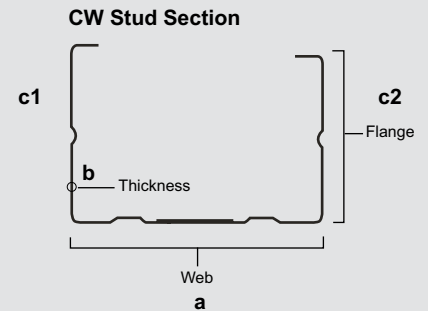
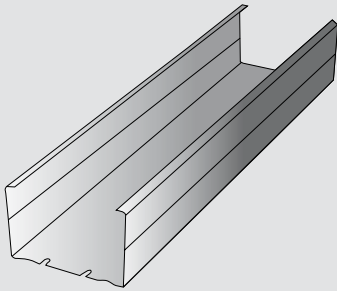

Knauf CW Studs are galvanized lightweight steel sections to be used as vertical stud framing for drywall partitions and wall linings. All CW Studs comply with EN14195.

Features:

- ✓ Asymmetrical flanges allow easy boxing of studs when necessary
- ✓ Readymade slots through the web for pipe electrical cabling

Mat.Code	Stud Type	Stud Web (a) (mm)	Stud thickness (b) (mm)	Stud Flange (c1,c2) (mm)	Stud Length ⁽¹⁾ (mm)	Weight (kg/m)	Zinc Coating Class ⁽²⁾ (g/m ²)
16487	Knauf CW50 Stud	50	0.5	35/33	3000	0.468	Z140
16488	Knauf CW70 Stud	70				0.543	
16489	Knauf CW75 Stud	75				0.562	
16490	Knauf CW92 Stud	92				0.625	
16491	Knauf CW146 Stud	146				0.827	

(1): 3000mm is the standard retail sales length of the studs. For customized stud lengths please contact Knauf LLC Sales Team

(2): Z140 is the standard retail zinc coating thickness sufficient for interior drywall applications. Higher zinc coated stud production also possible. For customized zinc coating requirements please contact Knauf LLC sales Team

Knauf UW Tracks

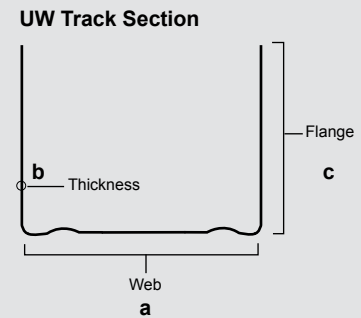
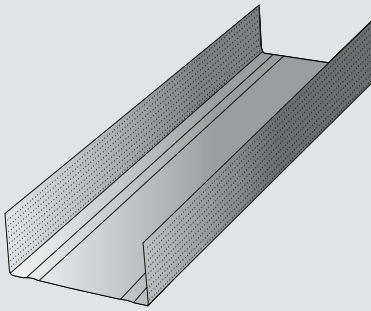

Knauf UW Channels are galvanized lightweight steel sections fixed to structural ceilings and slabs to form the metal framing perimeter for Knauf W11 Partitions and Knauf W623 Wall Lining Systems. All UW Tracks comply with EN14195.

Mat.Code	Channel Type	Channel Web (a) (mm)	Channel thickness (b) (mm)	Channel Flange (c)	Channel Length ⁽¹⁾	Weight (kg/m)	Zinc Coating Class ⁽²⁾ (g/m ²)
168492	Knauf UW50 Track	52	0.6	32	3000	0.511	Z140
168497	Knauf UW50 Track	52	0.5	25		0.373	
168493	Knauf UW70 Track	72	0.6	32		0.602	
168498	Knauf UW70 Track	72	0.5	25		0.448	
168494	Knauf UW75 Track	77	0.6	32		0.624	
168499	Knauf UW75 Track	77	0.5	25		0.414	
168495	Knauf UW92 Track	94	0.6	32		0.701	
168500	Knauf UW92 Track	94	0.5	25		0.531	
168496	Knauf UW146 Track	148	0.6	32		0.946	
168501	Knauf UW146 Track	148	0.5	25		0.682	

(1): 3000mm is the standard retail sales length of the channels. For customized channel lengths please contact Knauf LLC Sales Team

(2): Z140 is the standard retail zinc coating thickness sufficient for interior drywall applications. Higher zinc coated channel production also possible. For customized zinc coating requirements please contact Knauf LLC sales Team

Knauf Deep Flange UW Tracks

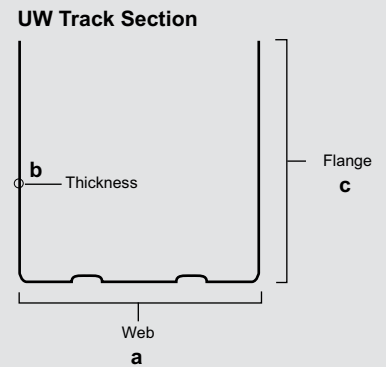
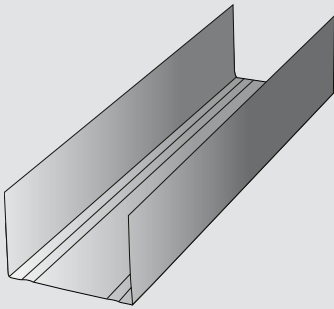

These are galvanized lightweight steel sections fixed to structural ceilings for deflection performance in partition and wall lining systems. Up to 40 mm deflection allowance is possible when used. All Deep Flange UW Tracks comply with EN14195.

Mat.Code	Track Type	Track Web (a) (mm)	Track thickness (b) (mm)	Track Flange (c) (mm)	Track Length ⁽¹⁾ (mm)	Weight (kg/m)	Zinc Coating Class ⁽²⁾ (g/m ²)
16482	Knauf Deep Flange UW 50 Track	52	0.6	60	3000	0.765	Z140
16484	Knauf Deep Flange UW 70 Track	72	0.6			0.855	
16486	Knauf Deep Flange UW 75 Track	75	0.6			0.878	
16483	Knauf Deep Flange UW 92 Track	94	0.6			0.955	
16485	Knauf Deep Flange UW 146 Track	148	0.6			0.1.199	

(1): 3000mm is the standard retail sales length of the Tracks. For customized Track lengths please contact Knauf LLC Sales Team

(2): Z140 is the standard retail zinc coating thickness sufficient for interior drywall applications. Higher zinc coated Track production also possible. For customized zinc coating requirements please contact Knauf LLC sales Team



Knauf CD Channels

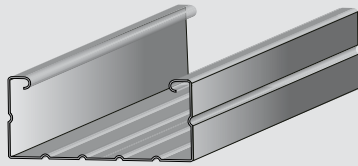

CD Channel Section

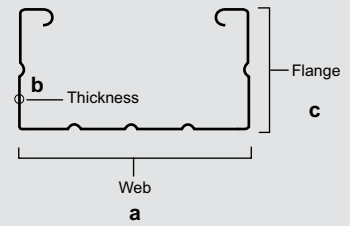

Knauf CD Channels are galvanized lightweight steel sections to be used as primary/main and secondary/furring channels for Knauf Ceiling Systems and also as furring channels for Knauf W623 Wall Lining Systems. Their increased web width allows faster and easier installation and smoother joints. All CD Channels comply with EN14195.

Features:

- ✓ Sturdy 0.6 mm sections with full set of compatible accessories
- ✓ Part of a complete ceiling system
- ✓ Only one type of channel for main and furring functions
- ✓ Increased web width for faster/easier installations and smoother joints

Mat.Code	Stud Type	Channel Web (a) (mm)	Channel thickness (b) (mm)	Channel Flange (c) (mm)	Channel Length ⁽¹⁾ (mm)	Weight (kg/m)	Zinc Coating Class ⁽²⁾ (g/m ²)
168479	Knauf CD Channel	48	0.6	26.5	3000	0.529	Z140
168481	Knauf CD Channel	58				0.584	

(1): 3000mm is the standard retail sales length of the channels. For customized channel lengths please contact Knauf LLC Sales Team

(2): Z140 is the standard retail zinc coating thickness sufficient for interior drywall applications. Higher zinc coated channel production also possible. For customized zinc coating requirements please contact Knauf LLC sales Team

Knauf UD Channel

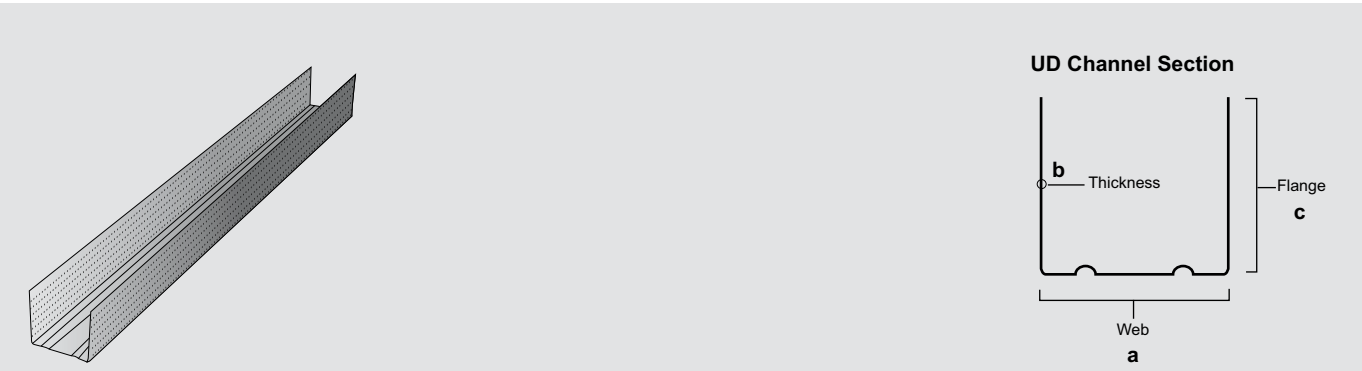

Knauf UD Channels are galvanized lightweight steel sections to be used as perimeter channels for Knauf D11 Ceiling and W623 Wall Lining Systems. All UD Channels comply with EN14195.

Mat.Code	Stud Type	Channel Web (a) (mm)	Channel thickness (b) (mm)	Channel Flange (c) (mm)	Channel Length ⁽¹⁾ (mm)	Weight (kg/m)	Zinc Coating Class ⁽²⁾ (g/m²)
168480	Knauf UD Channel	28.5	0.6	27	3000	0.360	Z140
169738	Knauf UD Channel	28.5	0.5	27	3000	0.360	Z140

- (1): 3000mm is the standard retail sales length of the channels. For customized channel lengths please contact Knauf LLC Sales Team
- (2): Z140 is the standard retail zinc coating thickness sufficient for interior drywall applications. Higher zinc coated channel production also possible. For customized zinc coating requirements please contact Knauf LLC sales Team



Knauf CT Shaftwall Stud

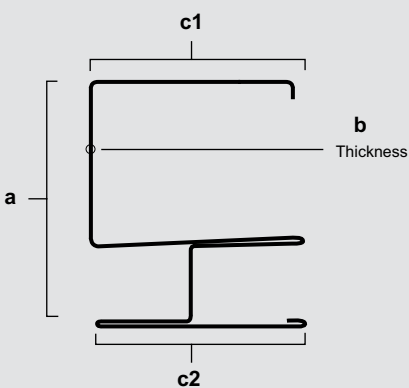
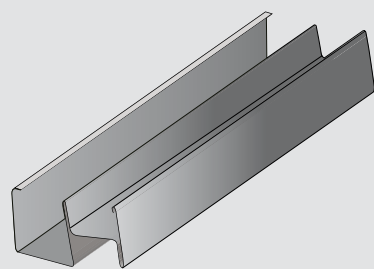

Knauf C-T Studs are high quality galvanized stell sections used in Knauf Shaftwall systems. It’s special design allows quick and easy installation of shaftwall constructions from one side only.

For more information on wall heights / fire protection / sound ratings of Knauf shaftwall systems please refer to W62 Technical Datasheet.

Features:

- ✓ Sturdy 0.9 mm steel sections for high performance shaftwalls.
- ✓ Special section designed for easy installation of shaftwall systems from one side only.

Mat. Code	Stud Type	Stud Web (a)	Stud thickness (b)	Stud Flange (c1,c2)	Stud Length(1)	Weight (kg/m)	Zinc Coating ⁽²⁾
168504	Knauf C- T 64 Stud	63.5	0.9mm	38/35	3000	1.506kg/m	Z140gr/m2
N/A	Knauf C- T 102 Stud	102				1.780kg/m	
N/A	Knauf C- T 152 Stud	152				2.140kg/m	

(1): 3000mm is the standard retail sales length of the studs. For customized stud lengths please contact Knauf LLC Sales Team

(2): Z140 is the standard retail zinc coating thickness sufficient for interior drywall applications. Higher zinc coated stud production also possible. For customized zinc coating requirements please contact Knauf LLC sales Team

Knauf J Shaftwall Track

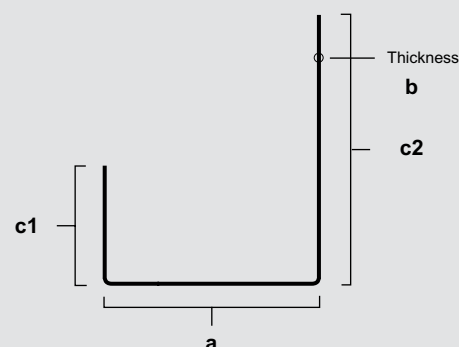
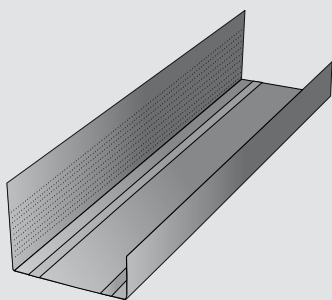

Knauf J Tracks are high quality galvanized steel sections used as perimeter framing section of the Knauf Shaftwall system.

For more information on wall heights / fire protection / sound ratings of Knauf shaftwall systems please refer to W62 Technical Datasheet.

Features:

- ✓ Sturdy 0.9 mm steel sections for high performance shaftwalls.
- ✓ Pullout tabs located at the web allows easy alignment of Knauf Coreboard during installation

Mat. Code	Channel Type	Channel Web (a)	Channel thickness (b)	Channel Flange (c1, c2)	Channel Length ⁽¹⁾	Weight (kg/m)	Zinc Coating ⁽²⁾	Packaging Unit
168505	Knauf J 64 Track	63.5mm	0.9mm	25/51	3000	0.994kg/m	Z140gr/m2	10pcs/bundle 80pcs/big bundle
N/A	Knauf J 102 Track	102mm				1.268kg/m		10pcs/bundle 80pcs/big bundle
N/A	Knauf J 152 Track	152mm				1.629kg/m		10pcs/bundle 80pcs/big bundle

(1): 3000mm is the standard retail sales length of the Tracks. For customized Track lengths please contact Knauf LLC Sales Team

(2): Z140 is the standard retail zinc coating thickness sufficient for interior drywall applications. Higher zinc coated Track production also possible. For customized zinc coating requirements please contact Knauf LLC sales Team

Knauf Hat Furring Channel

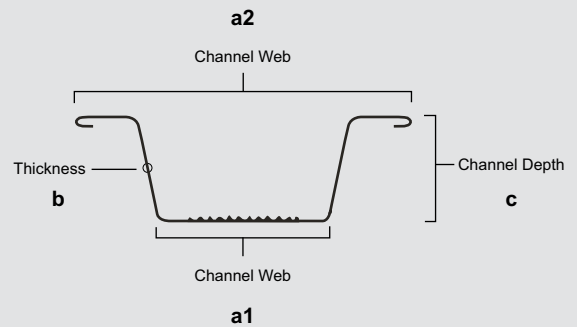
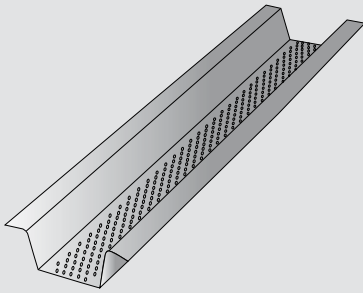

Galvanized lightweight steel sections to be used as furring channels for conventional drywall ceiling and wall lining systems. Deep dotting at the web allows for faster screwing times when cladding gypsum boards.

Mat.Code	Channel Type	Channel Web (a1, a2) (mm)	Channel thickness (b) (mm)	Channel Depth (c) (mm)	Channel Length ⁽¹⁾ (mm)	Weight (kg/m)	Zinc Coating Class ⁽²⁾ (g/m ²)
168503	Knauf Hat Furring Channel	35/67	0.5	22	3000	0.407	Z140

(1): 3000mm is the standard retail sales length of the channels. For customized channel lengths please contact Knauf LLC Sales Team

(2): Z140 is the standard retail zinc coating thickness sufficient for interior drywall applications. Higher zinc coated channel production also possible. For customized zinc coating requirements please contact Knauf LLC sales Team

Knauf Main Channel

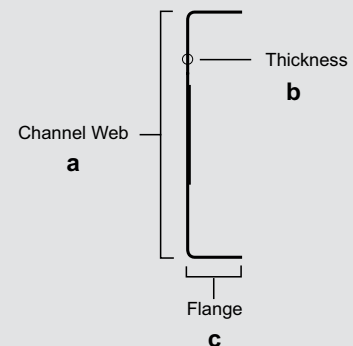
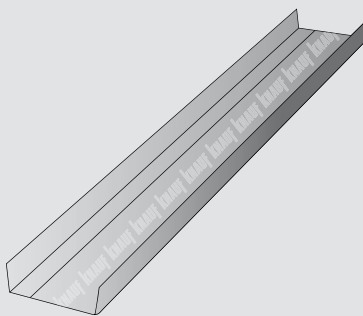

Galvanized lightweight steel sections to be used as main channels for conventional drywall ceiling systems.

Mat.Code	Channel Type	Channel Web (a) (mm)	Channel thickness (b) (mm)	Channel Flange (c) (mm)	Channel Length ⁽¹⁾ (mm)	Weight (kg/m)	Zinc Coating Class ⁽²⁾ (g/m ²)
168502	Knauf Main Channel	38	0.5	12	3000	0.227	Z140

(1): 3000mm is the standard retail sales length of the channels. For customized channel lengths please contact Knauf LLC Sales Team

(2): Z140 is the standard retail zinc coating thickness sufficient for interior drywall applications. Higher zinc coated channel production also possible. For customized zinc coating requirements please contact Knauf LLC sales Team

Knauf Angle Section

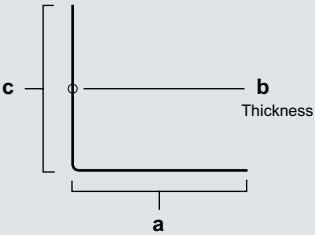
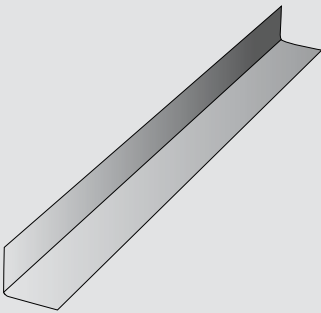

Galvanized lightweight steel sections to be used as perimeter framing for conventional drywall ceiling systems.

Mat.Code	Stud Type	Channel Web (a)	Channel thickness (b)	Channel Flange (c)	Channel Length ⁽¹⁾	Weight (kg/m)	Zinc Coating ⁽²⁾
168506	Knauf Angle Section	25mm	0.5mm	23mm	3000mm	0.175kg/m	Z140gr/m2

(1): 3000mm is the standard retail sales length of the channels. For customized channel lengths please contact Knauf LLC Sales Team

(2): Z140 is the standard retail zinc coating thickness sufficient for interior drywall applications. Higher zinc coated channel production also possible. For customized zinc coating requirements please contact Knauf LLC sales Team

Notes

This image shows a full page of white paper with horizontal dashed lines. The lines are evenly spaced and run across the width of the page, providing a guide for handwriting or typing. There are no margins, text, or other markings on the page.

Notes

[illegible]

We reserve the right to amend technical specifications without notice. The current edition applies. Our guarantee applies only to the defect-free state of our materials. The structural, static and physical characteristics of Knauf systems can only be ensured where only Knauf system components or products recommended by Knauf are used. Consumption, quantity and design specifications are typical figures, which may not be transferable under different circumstances. All rights reserved. Changes, reproductions and photo-mechanical and electronic repetition, even in part; require the specific permission of Knauf LLC, P.O. Box 112871, Dubai, United Arab Emirates.



Knauf

Technical Assistance:

▶ Tel. +971 4 337 7170

▶ info@knauf.ae

▶ www.knauf.ae

Knauf Drywall Systems publishes updated technical information on various products and topics. In order to request any of the brochures listed below, please contact our office at the address given below.

Knauf Drywall Systems Guide

Knauf Access Panels Brochure

Knauf Drywall Tools Brochure

Knauf Drywall Training Brochure

Knauf Cleaneo Acoustic Ceilings Brochure

D11 Knauf Ceilings Technical Datasheet

W11 Knauf Partitions Technical Datasheet

D12 Knauf Cleaneo Acoustic Ceilings Technical Datasheet

Knauf Access Panels Technical Brochure

Knauf LLC

P.O.Box 112871 Dubai United Arab Emirates

Tel.: +971 4 337 7170 Fax: +971 4 334 9659

Email: info@knauf.ae

www.knauf.ae